

Vibratory Finishing Bowl type machine

Type: EVP



TRUMLINGSAKTIEBOLAGET

Åldermansvägen 1, 171 48 SOLNA Tel: 08-446 60 10 trumlings@trumlings.se www.trumlings.se



EVP

Circular vibratory bowl type machine without internal separation device.

The EVP series is characterized by high stock removal, quality, and long lifespan. Noise proofing lid is standard.

Suitable for large or delicate parts requiring manual handling, it can be equipped with a carousel for compartmentalization to prevent parts from contacting each other.

The machine features a robust steel frame and is equipped with a high-efficiency vibration motor.

The control panel includes an electronic timer for process control, the machine can also be equipped with speed control and bottom unloading as options

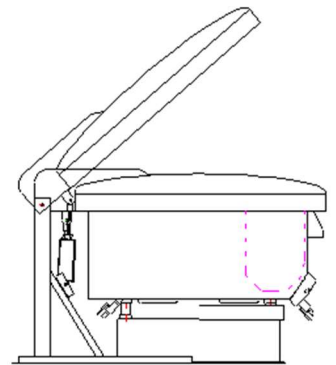
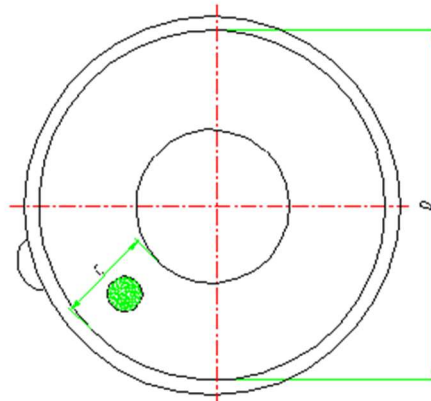
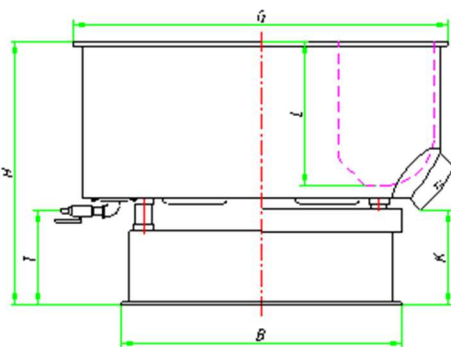

| TYP | VOLYM l | MOTOR- EFFEKT kW | VIKT kg | MATERIAL DIMENSION mm | INFORDRING TJOCKLEK mm | G mm | D mm | C mm | L mm | H mm | K mm | T mm | B mm |
|----------|------------|------------------------|------------|-----------------------------|------------------------------|---------|---------|---------|---------|---------|---------|---------|---------|
| EVP-30 | 30 | 0,55 | 120 | 5 | 18 | 595 | 500 | 150 | 210 | 885 | | 600 | 486 |
| EVP-110 | 120 | 1,1 | 260 | 5 | 18 | 865 | 750 | 265 | 320 | 870 | 430 | 450 | 630 |
| EVP-250 | 250 | 1,5 | 410 | 5 | 20 | 1128 | 1000 | 275 | 380 | 900 | 415 | 445 | 885 |
| EVP-400 | 400 | 2,2 | 620 | 5 | 20 | 1330 | 1200 | 340 | 440 | 1030 | 400 | 480 | 1060 |
| EVP-550 | 585 | 4 | 1040 | 6 | 25 | 1546 | 1400 | 390 | 510 | 1095 | 410 | 480 | 1220 |
| EVP-800 | 830 | 5,5 | 1270 | 8 | 30 | 1740 | 1600 | 445 | 560 | 1150 | 400 | 480 | 1365 |
| EVP-1100 | 1100 | 5,5 | 1450 | 8 | 30 | 1800 | 1660 | 540 | 610 | 1330 | 500 | 630 | 1400 |
| EVP-1500 | 1500 | 11 | 2300 | 8 | 30 | 2026 | 1860 | 580 | 685 | 1640 | 800 | 800 | 1580 |
| EVP-3000 | 3000 | 15 | 3350 | 8 | 30 | 2470 | 2300 | 760 | 780 | 1780 | 870 | 800 | 1950 |
| EVP-3500 | 3500 | 15 | 3720 | 8 | 30 | 2630 | 2460 | 830 | 780 | 1780 | 870 | 800 | 1950 |

TRUMLINGSAKTIEBOLAGET